

Licensing Act 2003

**Premises Licence****LEIPRM0924**

Licensing Authority Office  
Leicester City Council  
New Walk Centre  
Welford Place  
LEICESTER  
LE1 6ZG

## Part 1 - Premises Details

## POSTAL ADDRESS OF PREMISES, OR IF NONE, ORDNANCE SURVEY MAP REFERENCE OR DESCRIPTION

**Olives Lounge Cafe Bar**

95 Queens Road, Leicester, LE2 1TT

## WHERE THE LICENCE IS TIME LIMITED THE DATES

Not applicable.

Expires **no expiry**

## LICENSABLE ACTIVITIES AUTHORISED BY THE LICENCE

- a performance of live music
- any playing of recorded music
- the supply of alcohol

## THE TIMES THE LICENCE AUTHORIZES THE CARRYING OUT OF LICENSABLE ACTIVITIES

Activity (and Area if applicable)	Description	Time From	Time To
E. Performance of live music (Indoors)	Sunday	Noon	10:30pm
	Mon-Sat	11:00am	11:00pm
F. Playing of recorded music (Indoors)	Sunday	Noon	10:30pm
	Mon-Sat	11:00am	11:00pm
J. Supply of alcohol for consumption ON and OFF the premises	Sunday	Noon	10:30pm
	Mon-Sat	11:00am	11:00pm

## THE OPENING HOURS OF THE PREMISES

Description	Time From	Time To
Sunday	Noon	11:00pm
Mon-Sat	11:00am	11:30pm

## WHERE THE LICENCE AUTHORIZES SUPPLIES OF ALCOHOL WHETHER THESE ARE ON AND / OR OFF SUPPLIES

- J. Supply of alcohol for consumption ON and OFF the premises

## Part 2



Licensing Act 2003

# Premises Licence

# LEIPRM0924



Licensing Authority Office  
Leicester City Council  
New Walk Centre  
Welford Place  
LEICESTER  
LE1 6ZG

**NAME, (REGISTERED) ADDRESS, TELEPHONE NUMBER AND EMAIL (WHERE RELEVANT) OF HOLDER OF PREMISES LICENCE**

Anil Tailor

8 Turnbury Way, Leicester, Leicestershire, LE5 5TW  
[REDACTED]

**REGISTERED NUMBER OF HOLDER, FOR EXAMPLE COMPANY NUMBER, CHARITY NUMBER (WHERE APPLICABLE)**

**NAME, ADDRESS AND TELEPHONE NUMBER OF DESIGNATED PREMISES SUPERVISOR WHERE THE PREMISES LICENCE AUTHORISES THE SUPPLY OF ALCOHOL**

Anil TAILOR

**PERSONAL LICENCE NUMBER AND ISSUING AUTHORITY OF PERSONAL LICENCE HELD BY DESIGNATED PREMISES SUPERVISOR WHERE THE PREMISES LICENCE AUTHORISES FOR THE SUPPLY OF ALCOHOL**

Licence No: LEIPRS3012

Issued by Leicester





Licensing Authority Office  
Leicester City Council  
New Walk Centre  
Welford Place  
LEICESTER  
LE1 6ZG

## ANNEXES

## Annex 1 - Mandatory conditions

Supply of alcohol - on the premises

No supply of alcohol may be made under the premises licence -

- a) at a time when there is no designated premises supervisor in respect of the premises licence, or
- b) at a time when the designated premises supervisor does not hold a personal licence or his personal licence is suspended.

Every supply of alcohol under the premises licence must be made or authorised by a person who holds a personal licence.

The responsible person shall take all reasonable steps to ensure that staff on relevant premises do not carry out, arrange or participate in any irresponsible promotions in relation to the premises. In this paragraph, an irresponsible promotion means any one or more of the following activities, or substantially similar activities, carried on for the purpose of encouraging the sale or supply of alcohol for consumption on the premises in a manner which carries a significant risk of leading or contributing to crime and disorder, prejudice to public safety, public nuisance, or harm to children-

- a) games or other activities which require or encourage, or are designed to require or encourage, individuals to-
  - i) drink a quantity of alcohol within a time limit (other than to drink alcohol sold or supplied on the premises before the cessation of the period in which the responsible person is authorised to sell or supplied alcohol), or
  - ii) drink as much alcohol as possible (whether within a time limit or otherwise);
- b) provision of unlimited or unspecified quantities of alcohol free or for a fixed or discounted fee to the public or to a group defined by a particular characteristic (other than any promotion or discount available to an individual in respect of alcohol for consumption at a table meal, as defined in section 159 of the Act);
- c) provision of free or discounted alcohol or any other thing as a prize to encourage or reward the purchase and consumption of alcohol over a period of 24 hours or less;
- d) provision of free or discounted alcohol in relation to the viewing on the premises of a sporting event, where that provision is dependent on-
  - i) the outcome of a race, competition or other event or process, or
  - ii) the likelihood of anything occurring or not occurring;
- e) selling or supplying alcohol in association with promotional posters or flyers on, or in the vicinity of, the premises which can reasonably be considered to condone, encourage or glamourise anti-social behaviour or to refer to the effects of drunkenness in any favourable manner.

The responsible person shall ensure that no alcohol is dispensed directly by one person into the mouth of another (other than where that other person is unable to drink without assistance by reason of a disability).

The responsible person shall ensure that free tap water is provided on request to customers where it is reasonably available.

The premises licence holder or club premises certificate holder shall ensure that an age verification policy applies to the premises in relation to the sale or supply of alcohol. The policy must require individuals who appear to the responsible person to be under 18 years of age (or such older age as may be specified in the policy) to produce on request, before being served alcohol, identification bearing their photograph, date of birth and a holographic mark.

The responsible person shall ensure that-

- a) where any of the following alcoholic drinks is sold or supplied for consumption on the premises (other than alcoholic drinks sold or supplied having been made up in advance ready for sale or supply in a securely closed container) it is available to customers in the following measures-
  - i) beer or cider: ½ pint;
  - ii) gin, rum, vodka or whisky: 25 ml or 35 ml; and
  - iii) still wine in a glass: 125 ml, and

customers are made aware of the availability of these measures

Supply of alcohol - off the premises

No supply of alcohol may be made under the premises licence -

- a) at a time when there is no designated premises supervisor in respect of the premises licence, or
- b) at a time when the designated premises supervisor does not hold a personal licence or his personal licence is suspended.

Every supply of alcohol under the premises licence must be made or authorised by a person who holds a personal licence.

The premises licence holder or club premises certificate holder shall ensure that an age verification policy applies to the premises in relation to the sale or supply of alcohol. The policy must require individuals who appear to the responsible person to be under 18 years of age (or such





Licensing Authority Office  
Leicester City Council  
New Walk Centre  
Welford Place  
LEICESTER  
LE1 6ZG

**ANNEXES continued ...**

older age as may be specified in the policy) to produce on request, before being served alcohol, identification bearing their photograph, date of birth and a holographic mark.

**Annex 2 - Conditions consistent with the operating schedule**

The licence holder will join the Leicester Watch scheme operating in the area and will ensure that all instances of crime and disorder are reported.

The licence holder shall introduce a policy requiring the production of "proof of age" for any sale that takes place where there is any suspicion that the customer is under 18. Such proof may include a pass conforming to the PASS accreditation system, photo driving licence, student cards and passports.

The licence holder will not tolerate drug use at any time.

The licence holder will ensure that alcohol will not be sold to anyone who appears to be drunk and disorderly.

The licence holder will ensure that there is access throughout the premises for disabled customers.

The licence holder will ensure that there is a first aider on the premises at all times.

Children must be under the supervision of parents or guardians at all times.

**Annex 3 - Conditions attached after a hearing by the Licensing Authority**

Waste bottles will be disposed of in the morning to avoid any disturbance

All windows and doors will remain shut at all times, whatever the season except for access and egress.

All ground floor doors to be fixed, except those for entrance / egress. (Note: This relates to the concertina style doors)

On occasions when music is played, its noise must not be perceptible from behind any closed door in any nearby residences. In the event of any complaint being received, the licence holder will take immediate steps to stop the noise

There will be a daily collection of waste

All deliveries to or from the premises, including the collection of waste, will be restricted to between 10.00 and 19.00 hours

No rubbish will be left on the public highway

All rubbish will be disposed of in a safe, sealed container (not plastic sacks).

All drinking and eating will be restricted to within the premises

Prominent notices of an adequate size and adequately lit, will be displayed inside the premises inviting clients to leave quietly

All staff to leave via the Queens Road entrance in a quiet and orderly fashion

The shutter on the rear door will be closed quietly

CCTV will be installed and maintained internally and externally at all times, in accordance with the advice of the Crime Prevention Officer

Daily checks will be made to the rear of the premises with a view to maintaining cleanliness



G.F. LAYOUT

MAIN ENTRANCE ENTRANCE



F.F. LAYOUT

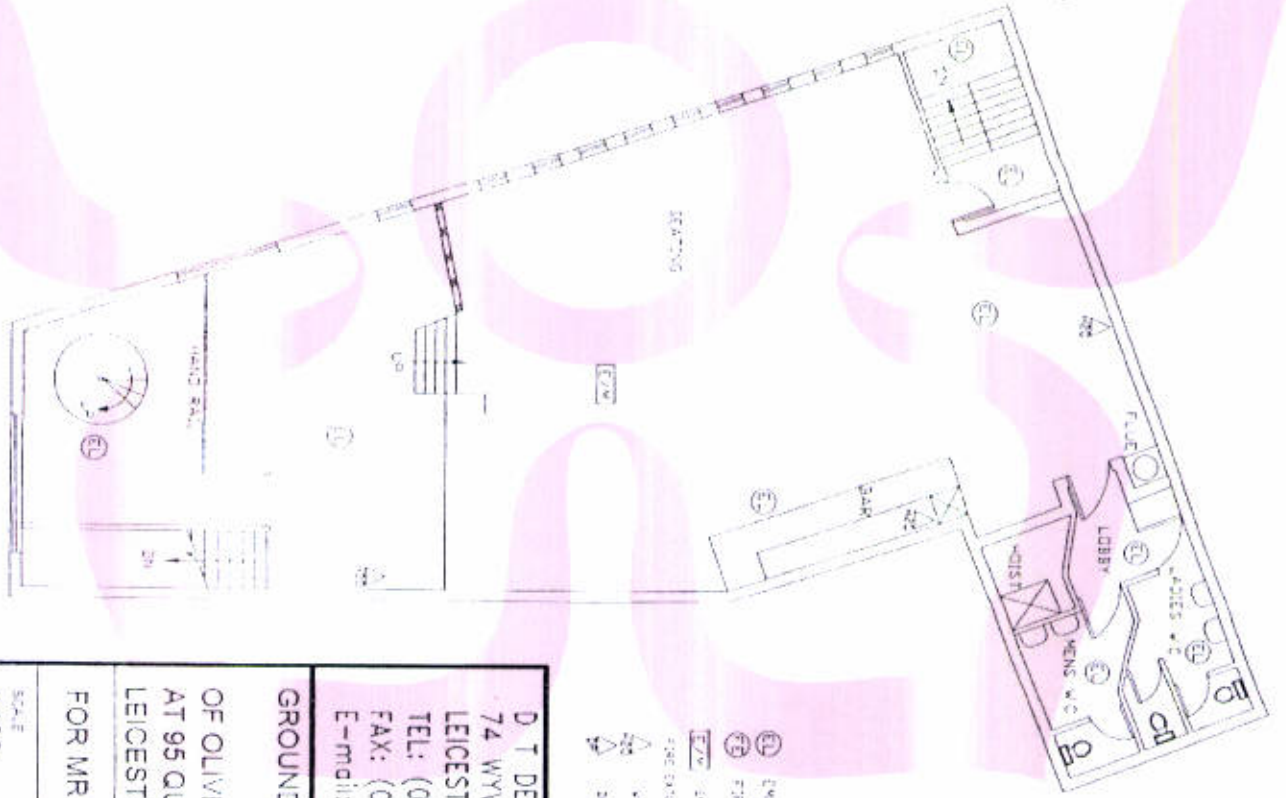

- ① EMERGENCY LIGHT 95 556/68 Pt 1
- ② FIRE EXIT DOOR
- ③ ENVIRONMENTAL MACHINE
- ④ WATER
- ⑤ SINK
- ⑥ SINK

**D T DESIGNS LIMITED**  
 74 WYVERN AVENUE  
 LEICESTER LE4 7HH  
 TEL: (0116) 2668947  
 FAX: (0116) 2200840  
 E-mail: dt.planning@ntlworld.com

**GROUND FLOOR LAYOUT**  
 & FIRST FLOOR LAYOUT  
 OF OLIVER'S LOUNGE CAFE BAR  
 AT 95 QUEENS ROAD  
 LEICESTER

**FOR MR H TAILOR**

SCALE	DATE
1:100	10/08/05
DRAWN BY	SS
05/08/146	

## Premises Licence Summary



Licensing Authority Office  
Leicester City Council  
New Walk Centre  
Welford Place  
LEICESTER  
LE1 6ZG

## Premises Details

## POSTAL ADDRESS OF PREMISES, OR IF NONE, ORDNANCE SURVEY MAP REFERENCE OR DESCRIPTION

**Olives Lounge Cafe Bar**

95 Queens Road, Leicester, LE2 1TT

## WHERE THE LICENCE IS TIME LIMITED THE DATES

Not applicable

## LICENSABLE ACTIVITIES AUTHORISED BY THE LICENCE

- a performance of live music
- any playing of recorded music
- the supply of alcohol

## THE TIMES THE LICENCE AUTHORISES THE CARRYING OUT OF LICENSABLE ACTIVITIES

Activity (and Area if applicable)	Description	Time From	Time To
E. Performance of live music (Indoors)	Sunday	Noon	10:30pm
	Mon-Sat	11:00am	11:00pm
F. Playing of recorded music (Indoors)	Sunday	Noon	10:30pm
	Mon-Sat	11:00am	11:00pm
J. Supply of alcohol for consumption ON and OFF the premises	Sunday	Noon	10:30pm
	Mon-Sat	11:00am	11:00pm

## THE OPENING HOURS OF THE PREMISES

Description	Time From	Time To
Sunday	Noon	11:00pm
Mon-Sat	11:00am	11:30pm

## WHERE THE LICENCE AUTHORISES SUPPLIES OF ALCOHOL WHETHER THESE ARE ON AND / OR OFF SUPPLIES

- J. Supply of alcohol for consumption ON and OFF the premises

## NAME, (REGISTERED) ADDRESS OF HOLDER OF PREMISES LICENCE

Anil Tailor

8 Turnbury Way, Leicester, Leicestershire, LE5 5TW



Licensing Act 2003

# Premises Licence Summary

# LEIPRM0924



Leicester  
City Council

Licensing Authority Office  
Leicester City Council  
New Walk Centre  
Welford Place  
LEICESTER  
LE1 6ZG

REGISTERED NUMBER OF HOLDER, FOR EXAMPLE COMPANY NUMBER, CHARITY NUMBER (WHERE APPLICABLE)

NAME OF DESIGNATED PREMISES SUPERVISOR WHERE THE PREMISES LICENCE AUTHORISES THE SUPPLY OF ALCOHOL

Anil TAILOR

STATE WHETHER ACCESS TO THE PREMISES BY CHILDREN IS RESTRICTED OR PROHIBITED

Restricted

